

CITY OF WILLIAMSPORT, PA RESOLUTION

RESOLUTION # 8868

DATE 3-28-19

TITLE

A RESOLUTION AWARDING THE CONTRACT FOR THE BRANDON PARK REHABILITATION PROJECT

BE IT HEREBY RESOLVED that the City Council of the City of Williamsport awards the contract for the Brandon Park Rehabilitation Project to Landserv Inc., P.O. Box 787, 309 North Street, Boalsburg, PA 16827, in the amount of \$428,569.00.

BE IT FURTHER RESOLVED that a copy of this resolution then be forwarded to Landserv Inc.

James M. Friend
City Clerk

Approved

[Signature]
President

**DEPARTMENT OF STREETS, PARKS
& FLOOD CONTROL**

Memorandum

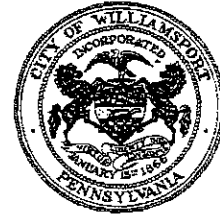

To: Mayor Gabriel J. Campana and Members of City Council
From: Adam Winder
Date: March 21, 2019
Re: Brandon Park Rehabilitation Project

Attached for City Council's review is a resolution awarding the contract for the Brandon Park Rehabilitation Project site to Landserv Inc. P.O. Box 787, 309 North Street, Boalsburg, Pa 16827, in the amount of \$428,569.00. Landserv Inc. submitted the lowest of four bids on February 4, 2019.

This project is being funded with Community Development block grant funds and a DCNR Bureau of Recreation and Conservation Grant. Attached is a copy of the Landserv Inc. proposal, along with the site plans from Stahl Shaffer Engineering.

We are requesting that City Council take action on the resolution of award Thursday, March 28, 2019.

Attachments

BID FORM
for
THE CITY OF WILLIAMSPORT
BRANDON PARK REHABILITATION PROJECT

Proposal of LANDSERY, INC
(hereinafter called "BIDDER"), organized and existing under the laws of the State of PA, doing business as (an individual) or (partnership) or (a corporation). To the City of Williamsport (hereinafter called "OWNER").

In compliance with your Advertisement for BIDS, BIDDER hereby proposes to perform all work for the construction of the **Brandon Park Rehabilitation Project**, located off Packer Street in Brandon Park, within the city of Williamsport, in strict accordance with the CONTRACT DOCUMENTS, within the time set forth therein, and at the prices stated below.

By submission of this BID, each BIDDER certifies, and in the case of a joint BID each party thereto certifies as to its own organization, that this BID has been arrived at independently, without consultation, communication, or agreement as to any matter relating to this BID with any other BIDDER or with any competitor.

BIDDER hereby agrees to commence WORK under this Contract on or before a date to be specified in the NOTICE TO PROCEED and to fully complete the PROJECT within 270 consecutive calendar days from the date the Notice to Proceed was issued.

BIDDER further agrees to pay as liquidated damages, the sum of **\$500.00** for each consecutive calendar day thereafter as provided in the GENERAL CONDITIONS.

BIDDER acknowledges receipt of the following ADDENDUM:

ADDENDUM #1 JAN 27 2019

ADDENDUM #2 JAN 29 2019

BIDDER agrees to perform all the work described in the CONTRACT DOCUMENTS for lump sum or unit prices listed in the Bid Schedule below.

All in strict accordance with the Specifications, Schedules, Drawings, and Conditions for the consideration of the following amounts, including federal, state, and all applicable taxes, for the sum of:

Base Bid - GENERAL

\$ 469,569.⁰⁰

FOUR HUNDRED SIXTY NINE THOUSAND FIVE HUNDRED SIXTY NINE AND ⁰⁰/₁₀₀
(write in dollar amount using words)

Base Bid - ELECTRIC

\$ N/A

(write in dollar amount using words)

Deduct Alternate #1 [△] - TENNIS COURT ELECTRIC & TENNIS COURT LIGHTING

\$ N/A

(write in dollar amount using words)

Deduct Alternate #2 [△] - TENNIS COURT CRACK REPAIR & SURFACE COATING

\$ 73,200.⁰⁰

SEVENTY THREE THOUSAND TWO HUNDRED AND ⁰⁰/₁₀₀
(write in dollar amount using words)

Unit Prices

Line Item	Item Description	Unit of Measurement	Quantity	Unit Price
1	PennDOT #2A Stone Subbase	TN	1	35. ⁰⁰
2	HMA Wearing Course (1.5" Depth)	SY	1	14. ¹⁰
3	HMA Base Course (3.5" Depth)	SY	1	28. ⁵⁰
5	Concrete Sidewalk	SY	1	117. ⁰⁰
6	Geotextile Stabilization Matting	SY	1	1. ⁰⁰
7	Topsoil	CY	1	54. ⁰⁰
8	Seeding & Mulching	SY	1	2. ⁶¹
9	Unclassified Excavation	CY	1	50. ⁰⁰
10	Pavement Saw Cutting	LF	1	6. ⁰⁰
11	6" High, Full Depth Concrete Curb	LF	1	100. ⁰⁰
12	Pavement Subgrade Preparation	SY	1	40. ⁰⁰
13	Tennis Court Crack Repair	LF	1	12. ⁰⁰

Submitted By:

LANDSERV INC

Federal ID Number:

23-2955162

Address:

PO Box 787; 309 N. CHURCH ST
BOALSBURG PA 16827

Signed By:

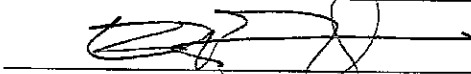

Authorized Signature

Attest:

Karen Adams

Surety Name:

The Cincinnati Insurance Co

Surety Address:

6200 S. Guilmore Rd
Yonkers, OH 45014-5141

Date:

1-30-19

PROJECT EXPERIENCE FORM

Brandon Park Rehabilitation Project
DCNR Project #LWCF 42-01595
The City of Williamsport
Lycoming County, Pennsylvania

Nature Play or Playground Project

Project Name: MILLBROOK MARSH NATURE CENTER

Completion Date SPRING 2016

Description: TSA PATHWAYS, RAIN GARDEN INSTALLATIONS, PARKING LOT ADA

Location: STATE COLLEGE, PA

Owner: CENTRE COUNTY PARKS AND RECREATION

Owner Contact Information: OWNER AT TIME OF PROJECT HAS RETIRED. PLEASE CONTACT
ROD STAHL, ENGINEER FOR PROJECT. 814 689-1562

Bidder's Role: Primary Contractor Sub-Contractor

Tennis Court Surfacing Project SEE ATTACHED REFERENCE SHEET

Project Name: _____

Completion Date: _____

Description: _____

Location: _____

Owner: _____

Owner Contact Information: _____

Bidder's Role: Primary Contractor Sub-Contractor

Lighting Project (if applicable to Bid)

Project Name: _____

N/A

Completion Date: _____

Description: _____

Location: _____

Owner: _____

Owner Contact Information: _____

Bidder's Role: Primary Contractor Sub-Contractor

BUSINESS REFERENCE

FOR ALTSMAN COATINGS

Tennis Court Resurfacing : PERSONAL REFERENCES

Mike Rich – SealMaster/ SportMaster

Mike.Rich@sealmasterhillsville.com

(724)730-1666

Harry Marshall - Southwest Greens, Pittsburgh

harrydmarshall@gmail.com

412-848-9243

Al Burick – Shenango Twp

aburick@shenangotwp.com

724-658-4460

PROJECT REFERENCES :

Louisville Metro Park and Rec

Wyandotte Park

Jason : Project Manager

502-574-7275

1 tennis court, 6 pickleball courts and 1 futsal court

Bardstown Parks and Recreation

Daniel: Director of park & rec's

djeffries@bardstowncable.net

502-348-9281

2 new tennis courts and 1 basketball court

Ellwood City Borough

Linda List – Boro secretary

724-758-7777

Resurfacing and color coating 4 new tennis courts

STAHL SHEAFFER ENGINEERING

Stahl Sheaffer Engineering
301 Science Park Road, Suite 333
State College, PA 16803
Phone: (814) 689-1562

Contract: Brandon Park Rehabilitation Project
City of Williamsport, Lycoming County, PA
Bidders:

	DEPARTMENT	DESCRIPTION	UNIT	QUANTITY	UNIT PRICE	TOTAL	EST. TOTAL	EST. TOTAL	EST. TOTAL	EST. TOTAL																																																																													
1	Glenn Hawbaker				\$ 480,862.00	\$ 57,500.00	\$ 423,182.00																																																																																
2	Mid State Paving				\$ 489,000.00	\$ 46,477.00	\$ 452,523.00																																																																																
3	HRI				\$ 483,815.00	\$ 49,553.00	\$ 434,062.00																																																																																
4	Landserv				\$ 499,569.00	\$ 73,200.00	\$ 396,369.00																																																																																
5																																																																																							
6																																																																																							
7																																																																																							
8																																																																																							
9																																																																																							
10																																																																																							
<table border="1"> <thead> <tr> <th></th> <th>DEPARTMENT</th> <th>DESCRIPTION</th> <th>UNIT</th> <th>QUANTITY</th> <th>UNIT PRICE</th> <th>TOTAL</th> <th>EST. TOTAL</th> <th>EST. TOTAL</th> <th>EST. TOTAL</th> <th>EST. TOTAL</th> </tr> </thead> <tbody> <tr> <td>1</td> <td>Howard Company</td> <td></td> <td></td> <td></td> <td>\$ 129,500.00</td> <td>\$ 79,800.00</td> <td>\$ 50,000.00</td> <td></td> <td></td> <td></td> </tr> <tr> <td>2</td> <td>Appellation Construction</td> <td></td> <td></td> <td></td> <td>\$ 160,745.00</td> <td>\$ 98,055.00</td> <td>\$ 62,691.00</td> <td></td> <td></td> <td></td> </tr> <tr> <td>3</td> <td>Lecca Electric</td> <td></td> <td></td> <td></td> <td>\$ 136,400.00</td> <td>\$ 79,100.00</td> <td>\$ 60,300.00</td> <td></td> <td></td> <td></td> </tr> <tr> <td>4</td> <td></td> <td></td> <td></td> <td></td> <td></td> <td></td> <td></td> <td></td> <td></td> <td></td> </tr> <tr> <td>5</td> <td></td> <td></td> <td></td> <td></td> <td></td> <td></td> <td></td> <td></td> <td></td> <td></td> </tr> <tr> <td>6</td> <td></td> <td></td> <td></td> <td></td> <td></td> <td></td> <td></td> <td></td> <td></td> <td></td> </tr> </tbody> </table>												DEPARTMENT	DESCRIPTION	UNIT	QUANTITY	UNIT PRICE	TOTAL	EST. TOTAL	EST. TOTAL	EST. TOTAL	EST. TOTAL	1	Howard Company				\$ 129,500.00	\$ 79,800.00	\$ 50,000.00				2	Appellation Construction				\$ 160,745.00	\$ 98,055.00	\$ 62,691.00				3	Lecca Electric				\$ 136,400.00	\$ 79,100.00	\$ 60,300.00				4											5											6										
	DEPARTMENT	DESCRIPTION	UNIT	QUANTITY	UNIT PRICE	TOTAL	EST. TOTAL	EST. TOTAL	EST. TOTAL	EST. TOTAL																																																																													
1	Howard Company				\$ 129,500.00	\$ 79,800.00	\$ 50,000.00																																																																																
2	Appellation Construction				\$ 160,745.00	\$ 98,055.00	\$ 62,691.00																																																																																
3	Lecca Electric				\$ 136,400.00	\$ 79,100.00	\$ 60,300.00																																																																																
4																																																																																							
5																																																																																							
6																																																																																							

Bidding Period: 1/14/2019 to 2/4/2019, 2:30 PM
Award Status: Project has not been awarded

Bidding has Closed

**ENGINEER'S ESTIMATE OF PROBABLE COST
FOR
BRANDON PARK REHABILITATION
CONCEPTUAL DESIGN
LOCATED IN
CITY OF WILLIAMSPORT
LYCOMING COUNTY, PA**

19-Dec-18

ITEM	QTY	UNIT	UNIT PRICE	ITEM COST	SUBTOTAL
GENERAL SITE					
CLEARING & GRUBBING	1	LS	\$ 2,000.00	\$	2,000.00
MOBILIZATION	1	LS	\$ 2,000.00	\$	2,000.00
TREE REMOVAL	1	LS	\$ 400.00	\$	400.00
E&S CONTROLS	1	LS	\$ 7,500.00	\$	7,500.00
NATURE PARK PROJECT SIGN	1	LS	\$ 1,500.00	\$	1,500.00
CONCRETE SIDEWALK (5' WIDE) (Main Sidewalk + Tennis Court)	410	SY	\$ 85.00	\$	34,850.00
STANDARD ASPHALT PAVING (HMA Base, Wearing, 2A Subbase)	400	SY	\$ 60.00	\$	24,000.00
ASPHALT MILL AND OVERLAY	800	SY	\$ 12.00	\$	9,600.00
CONCRETE CURB	250	LF	\$ 15.00	\$	3,750.00
TENNIS COURT CRACK AND SEAL COATING	1	LS	\$ 30,000.00	\$	30,000.00
ADA RAMPS W/ DETECTABLE WARNING SURFACE	2	EA	\$ 2,500.00	\$	5,000.00
ADJUST INLETS	2	EA	\$ 500.00	\$	1,000.00
STORM INLET TYPE C	2	EA	\$ 2,600.00	\$	5,200.00
12" STORM SEWER	75	LF	\$ 55.00	\$	4,130.00
SUBTOTAL					\$ 130,930.00
SITE ELECTRIC & LIGHTING					
TENNIS COURT					
Exterior distribution panel (200 amp, 30 pole)	1	EA	\$6,500.00		\$6,500.00
Astronomic time clock	1	EA	\$680.00		\$680.00
Push button timer switch	2	EA	\$475.00		\$950.00
Replace conductors to poles (#8 in existing)	750	FT	\$6.00		\$4,500.00
Light poles -- 30' aluminum, 2-or-4 head	8	EA	\$4,000.00		
Light Base Replacement	8	EA	\$1,250.00		\$10,000.00
Light fixtures -- Hydrel 8200	24	EA	\$850.00		\$20,400.00
WALKING PATH					\$ 40,030.00
Lighted bollards -- Lithonia DSXB	8	EA	\$1,100.00		\$8,800.00
Wiring to bollards (from pool house, #10 in PVC)	650	FT	\$13.50		\$8,775.00
Miscellaneous boxes, fittings, etc.	1	LS	\$1,250.00		\$1,250.00
PARKING LOT					\$ 18,825.00
Light poles -- 20' aluminum, 1 head (Reuse 1 Green Alum. Pole, 1 Proposed)	1	EA	\$2,600.00		\$2,600.00
Wiring to bollards (from pool house, #10 in PVC)	250	FT	\$13.50		\$3,375.00
Miscellaneous boxes, fittings, etc.	1	LS	\$900.00		\$900.00

OPTIONAL EXTERIOR PANELBOARD AT POOLHOUSE				
200-amp, 30-pole, NEMA 3R enclosure	1	EA	\$8,000.00	\$8,000.00
Meter socket	1	EA	\$400.00	\$400.00
Miscellaneous boxes, fittings, connections, etc.	1	LS	\$1,500.00	\$1,500.00
SUBTOTAL				\$16,775.00
				\$75,630.00

NATURE PLAY				
NATURE PLAY (w/Landscaping, Homestead Play House, Sidewalk, Natural Play Components, Edible Landscape, Interp. Signs) (See supporting estimate for detail)	1	LS	\$ 125,500.00	\$ 125,500.00
SUBTOTAL				\$125,500.00

NORTHERN BIORETENTION AREA				
LANDSCAPING	1	LS	\$ 5,000.00	\$ 5,000.00
FINE GRADING	1	LS	\$ 2,000.00	\$ 2,000.00
INTERPRETIVE SIGN	1	EA	\$ 300.00	\$ 300.00
SUBTOTAL				\$7,300.00

SOUTHERN BIORETENTION AREA				
LANDSCAPING	1	LS	\$ 7,000.00	\$ 7,000.00
FINE GRADING	1	LS	\$ 3,000.00	\$ 3,000.00
INTERPRETIVE SIGN	1	EA	\$ 300.00	\$ 300.00
8" HDPE PIPE	100	EA	\$ 40.00	\$ 4,000.00
STORMWATER INLET	3	EA	\$ 2,500.00	\$ 7,500.00
STORMWATER INLET CONNECTION	1	EA	\$ 300.00	\$ 300.00
RIP RAP APRON	4	EA	\$ 300.00	\$ 1,200.00
STEPPING STONE	6	EA	\$ 100.00	\$ 600.00
CONCRETE SIDEWALK (5' WIDE)	58	SY	\$ 85.00	\$ 4,930.00
IMPROVED WALKING PATH	45	SY	\$ 45.00	\$ 2,030.00
SUBTOTAL				\$30,860.00

SUBTOTAL	\$	370,220.00
11% CONTINGENCY	\$	40,724.00
TOTAL	\$	410,944.00

City of Williamsport Brandon Park – Nature Playground PRELIMINARY ESTIMATE OF PROBABLY COST 031218

Estimates:

Brandon Park - Nature Playground

Plan and Construction Drawings
The City of Williamsport, Lycoming County, Pennsylvania



BSA / LA, LLC
1605 E. Avenue / Lycoming Architecture
132 Palomares Circle
Williamsport, PA 17747
Tel: 717.326.5151
www.bsalola.com

City of Williamsport
Brandon Park -
Nature Playground
Plan and Construction Drawings
Irene May, Surveyor
Stacy Sharfetter Engineering, LLC



SHEET
1 of 1

Nature Play and Traditional Playground Combination

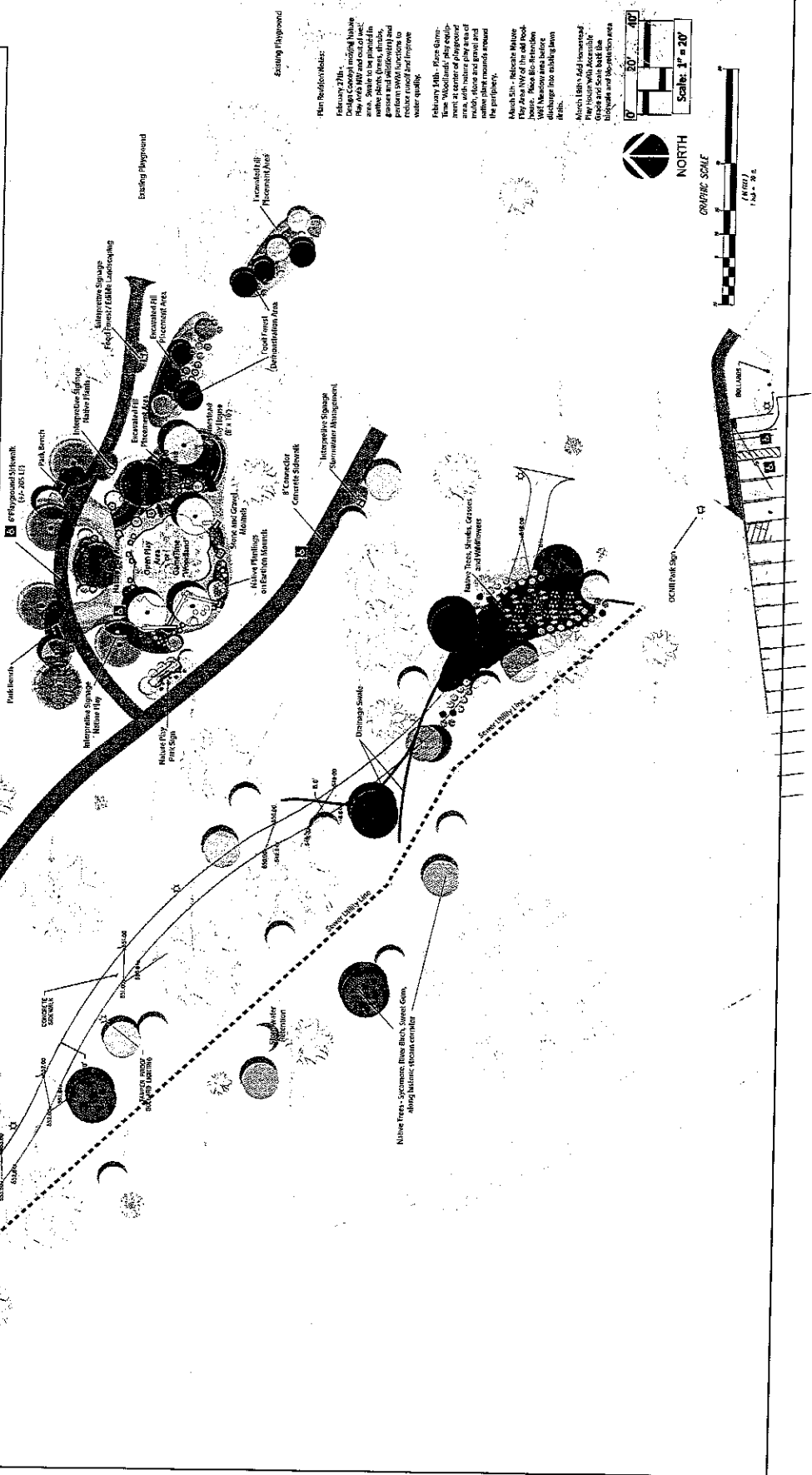

Plan Revision Notes:
 1. Update Title - From Brandon Park - Nature Playground to Brandon Park - Nature Playground
 2. Update Concept and Nature Play Area MW and out of MW. Area to be placed in future playground area. Update to include playground equipment and additional information to perform SWM functions to improve water quality.
 3. Update Title - From Brandon Park - Nature Playground to Brandon Park - Nature Playground
 4. Update Concept and Nature Play Area MW of the MW area, with nature play area of future playground area. Update to include playground equipment and additional information to perform SWM functions to improve water quality.
 5. Update Title - From Brandon Park - Nature Playground to Brandon Park - Nature Playground
 6. Update Concept and Nature Play Area MW of the MW area, with nature play area of future playground area. Update to include playground equipment and additional information to perform SWM functions to improve water quality.

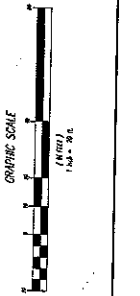

Brandon Park - Nature Playground

Plan and Construction Drawings
The City of Williamsport, Lycoming County, Pennsylvania



BSA / LA, LLC
1234 Main Street
Williamsport, PA 17707
Tel: 717-326-1234
www.bslala.com

City of Williamsport
Brandon Park -
Nature Playground
Plan and Construction Drawings



SHEET
1 of 1

Plan Revision Notes:
February 14th - Price Quote
Time: 10:00am - 10:30am
Meeting at location of playground
to discuss site and play area of
nature playground. Review of
native plant material around
the periphery.
March 15th - Move Nature Play
area to the NW. Simplify the
play area. Review of native
plant material around the
periphery.

